



Hello John,

Thank you for the opportunity to bid on the **2026-2029 EANGUS National Conference**.

The Birmingham-Jefferson Convention Complex is a multi-purpose facility in the heart of Entertainment District. Here you will find everything you need for whatever your event requires: an array of best-in-class facilities, upscale guest rooms in our adjoining Westin Birmingham and Sheraton Birmingham Hotels and diverse entertainment options conveniently located on the campus.

I welcome the opportunity to discuss our proposal in more detail.

Sincerely,

Alex Abenoja
Senior Convention Sales Manager

Birmingham Jefferson Convention Center
2100 Richard Arrington Jr. Blvd. N,
Birmingham, AL 35243
T: (205) 458-8214 E: alex.abenoja@bjcc.org

Birmingham Jefferson Convention Complex (space only)

Dates available: **August 7-13, 2026**
 August 6-13, 2027
 August 4-11, 2028
 August 3-10, 2029

Meeting Space:

Exhibits North Hall 123
General Session East Hall 2
Gala East Hall 3
Breakouts East Meeting Rooms A-O, Forum Rooms ABC, GHI

Total Room Rental for each year: \$37,800 discounted from \$75,600.

F&B Min: \$75,000 exclusive of tax and service charge.

Concessions:

15% off of Audio-Visual Equipment if Encore is used exclusively.
Group may use its own A/V company at no additional charge. Patch fees may apply.
We will offer group event discounted rate for Wi-Fi needs for 100 users or above.
Complimentary basic Wi-Fi in foyer/public area.
Complimentary set-up of tables and chairs in meeting rooms and general session room set in theater style.
Linens are extra except in meal rooms.
Complimentary staging up to 16' x 24' size.

BJCC service partners:

BJCC Caterer: Sodexo Live!
Utility/Power: Edlen Electric
IT/Telecom: BJCC IT/Telecom
Audio Visual: Encore **(preferred)**

BJCC is a non-union facility except for Riggers/Stagehands.

Medics will be required during event times/days.

Staffing required during event days.

F&B tax is 10%. Service charge is 23.5% (taxable)

Sleeping Room proposal to be provided by our partners, Sheraton/Westin Birmingham Hotels.

NORTH EXHIBITION HALLS

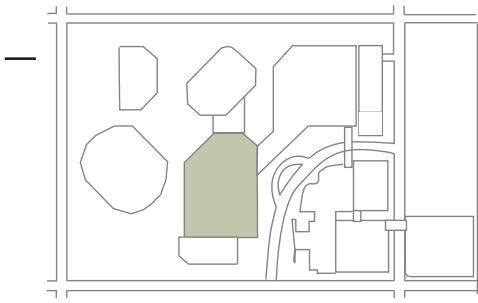

Room	Approx Sq Ft	Ceiling Height	10'x10' Booths	Theatre	Classroom	Banquet Round
North	94,269	25' 10"	428	9,656	3,360	5,000
North 1	34,609	25' 10"	120	2,800	1,044	1,600
North 2	27,656	25' 10"	116	2,800	1,044	1,600
North 3	32,004	25' 10"	116	2,800	1,044	1,600

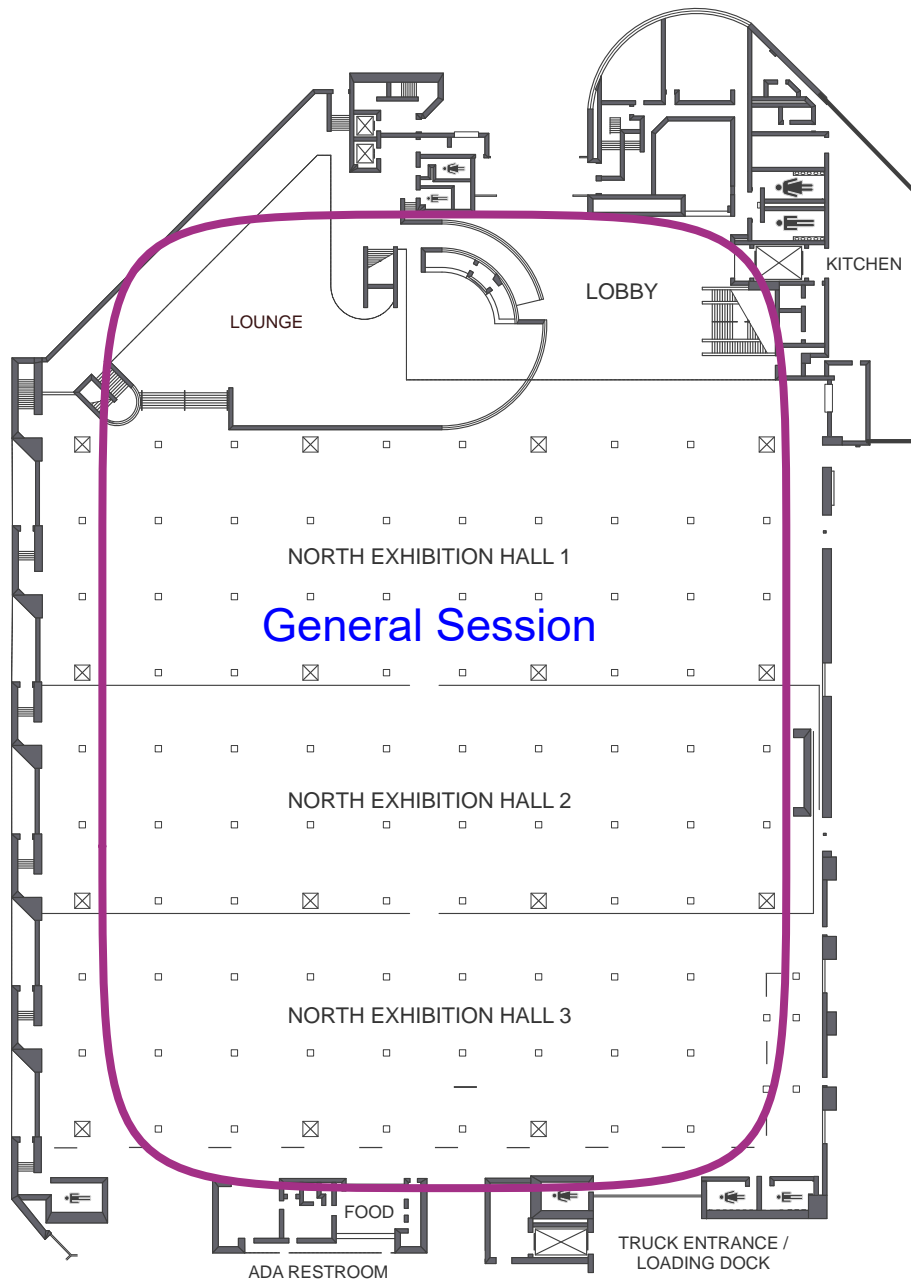

EAST EXHIBITION HALL

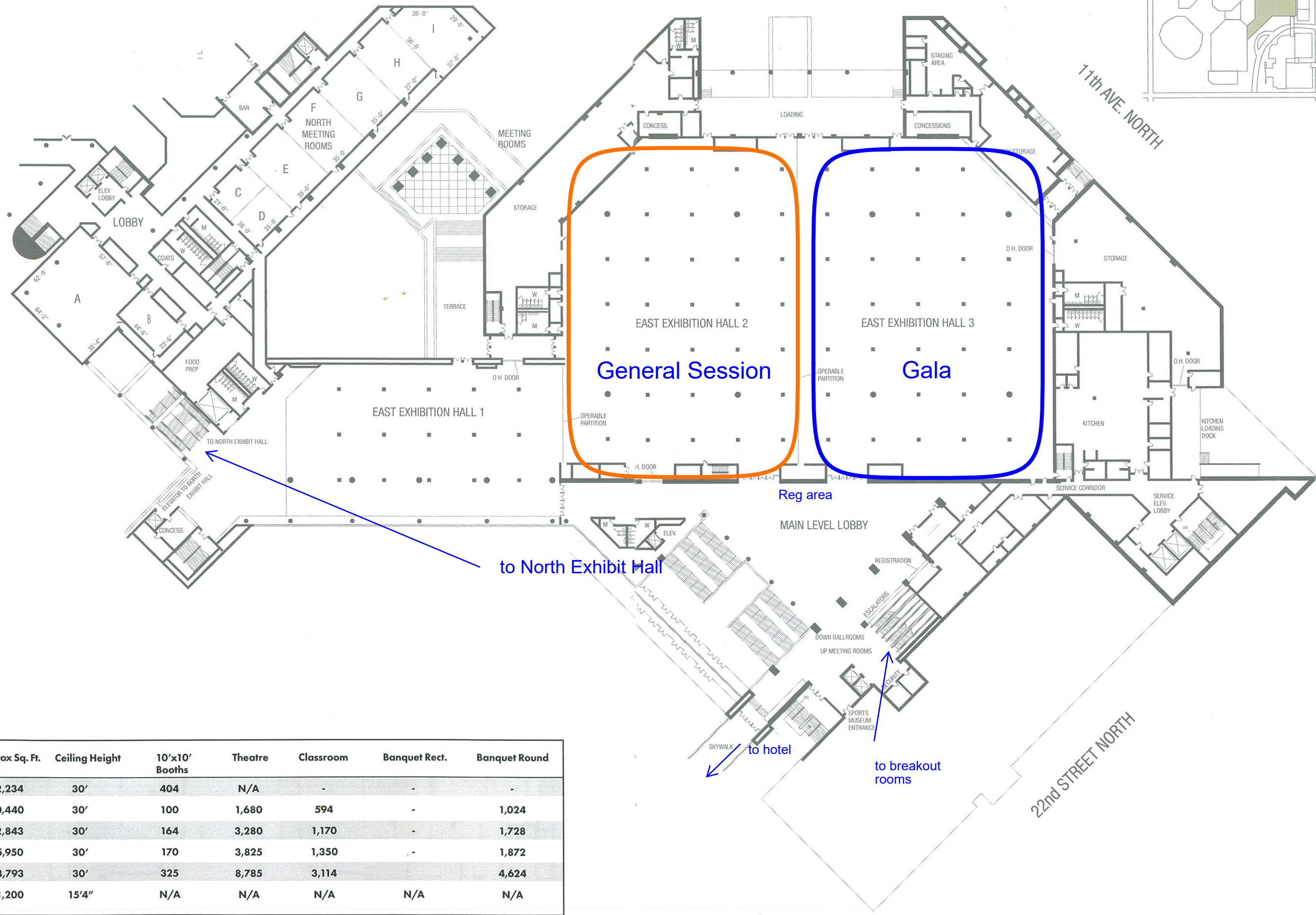

Room	Approx Sq. Ft.	Ceiling Height	10'x10' Booths	Theatre	Classroom	Banquet Rect.	Banquet Round
East 1,2,3	92,234	30'	404	N/A	-	-	-
East 1	20,440	30'	100	1,680	594	-	1,024
East 2	32,843	30'	164	3,280	1,170	-	1,728
East 3	35,950	30'	170	3,825	1,350	-	1,872
East 2-3	68,793	30'	325	8,785	3,114	-	4,624
Lobby	21,200	15'4"	N/A	N/A	N/A	N/A	N/A

EAST MEETING ROOMS

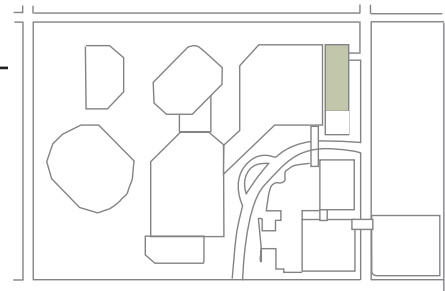

Room	Approx Sq. Ft.	Ceiling Height	Theatre	Classroom	Banquet
Ballroom A-B	14,045	21'	1,763	540	800
Ballroom A	5,535	21'	700	192	280
Ballroom B	8,509	21'	1,056	336	510
East A-C	3,825	12'	392	150	240
East A	1,275	12'	140	45	72
East B	1,275	12'	140	45	72
East C	1,275	12'	140	45	72



EAST MEETING ROOMS

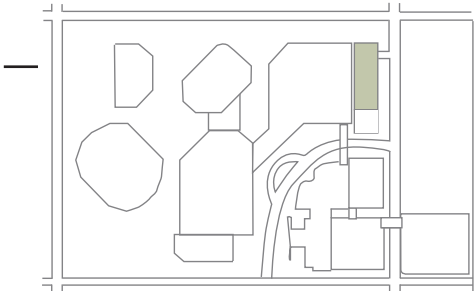

Room	Approx Sq Ft	Ceiling Height	Conference	Theatre	Classroom	U-Shape	Banquet
East D-M	14,193	-	-	1,850	588	-	768
East D	1,444	14'8"	42	119	45	32	64
East E	972	14'8"	32	70	40	26	48
East F	1,028	14'8"	32	84	48	26	48
East G	715	14'8"	24	50	24	21	32
East H	717	14'8"	24	50	24	21	32
East I	717	14'8"	24	50	24	21	32
East J	1,030	14'8"	36	84	42	25	48
East K	980	14'8"	32	70	42	25	48
East L	1,363	14'8"	44	119	45	35	64
East M	5,289	16'	-	663	216	-	244
East N-O	6,428	14'8"	-	780	270	-	400
East N	3,529	14'8"	-	380	144	-	248
East O	2,892	14'8"	-	352	120	-	192
VIP Lounge	2,790	9'4"	-	-	-	-	-

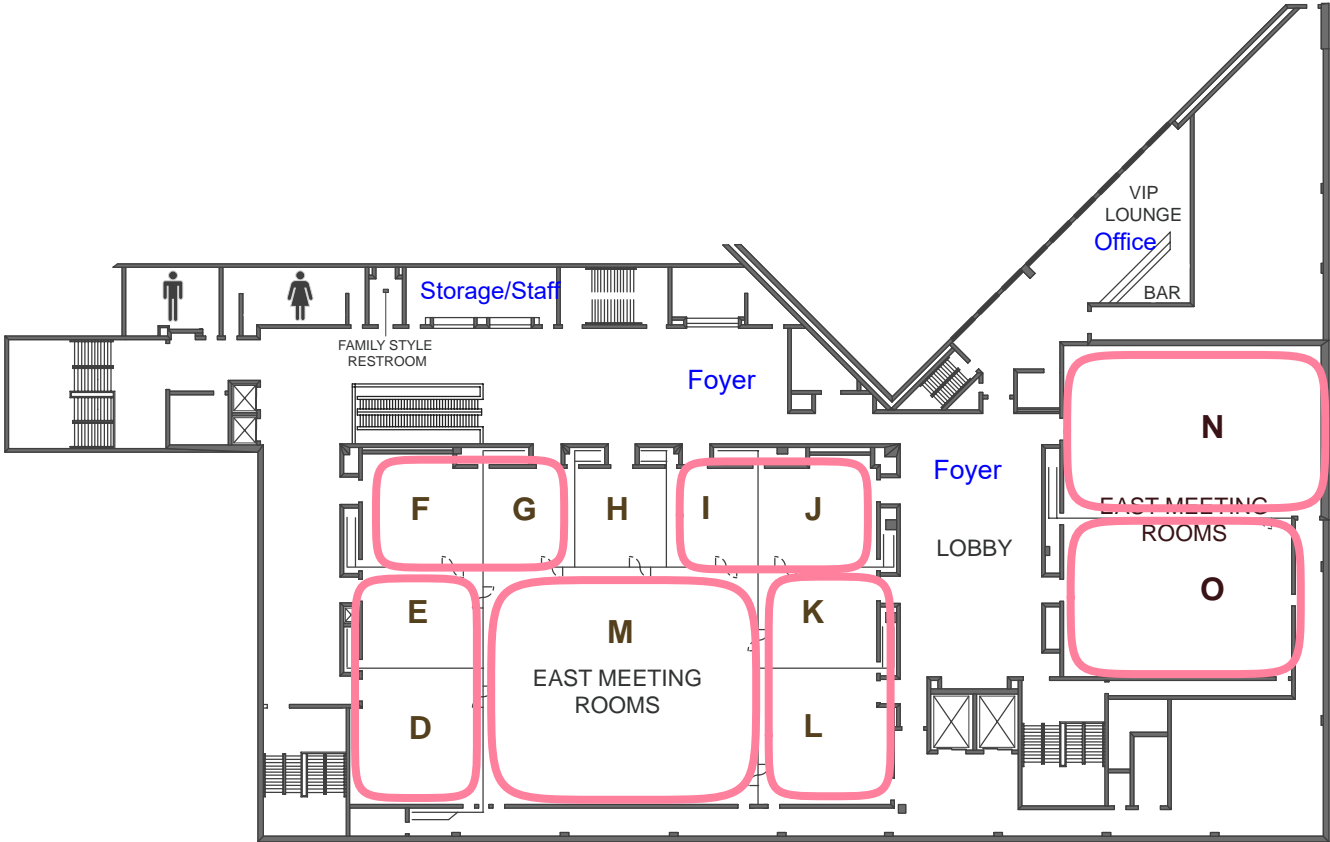

FORUM BUILDING 2ND FLOOR

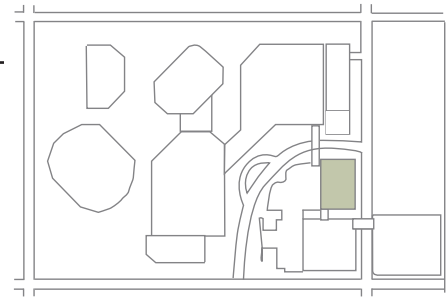

Room	Approx Sq Ft	Ceiling Height	Conference	Theatre	Classroom	U-Shape	Banquet
Theater	3,750		-	275	275	-	-
A	1,862	12'	54	192	66	47	112
B	1,900	12'	54	224	81	47	120
C	1,400	12'4"	40	168	54	38	96
D	639	10'	20	70	24	20	40
E	1,720	12"	-	-	51	-	-
F	632	10"	20	70	24	20	40

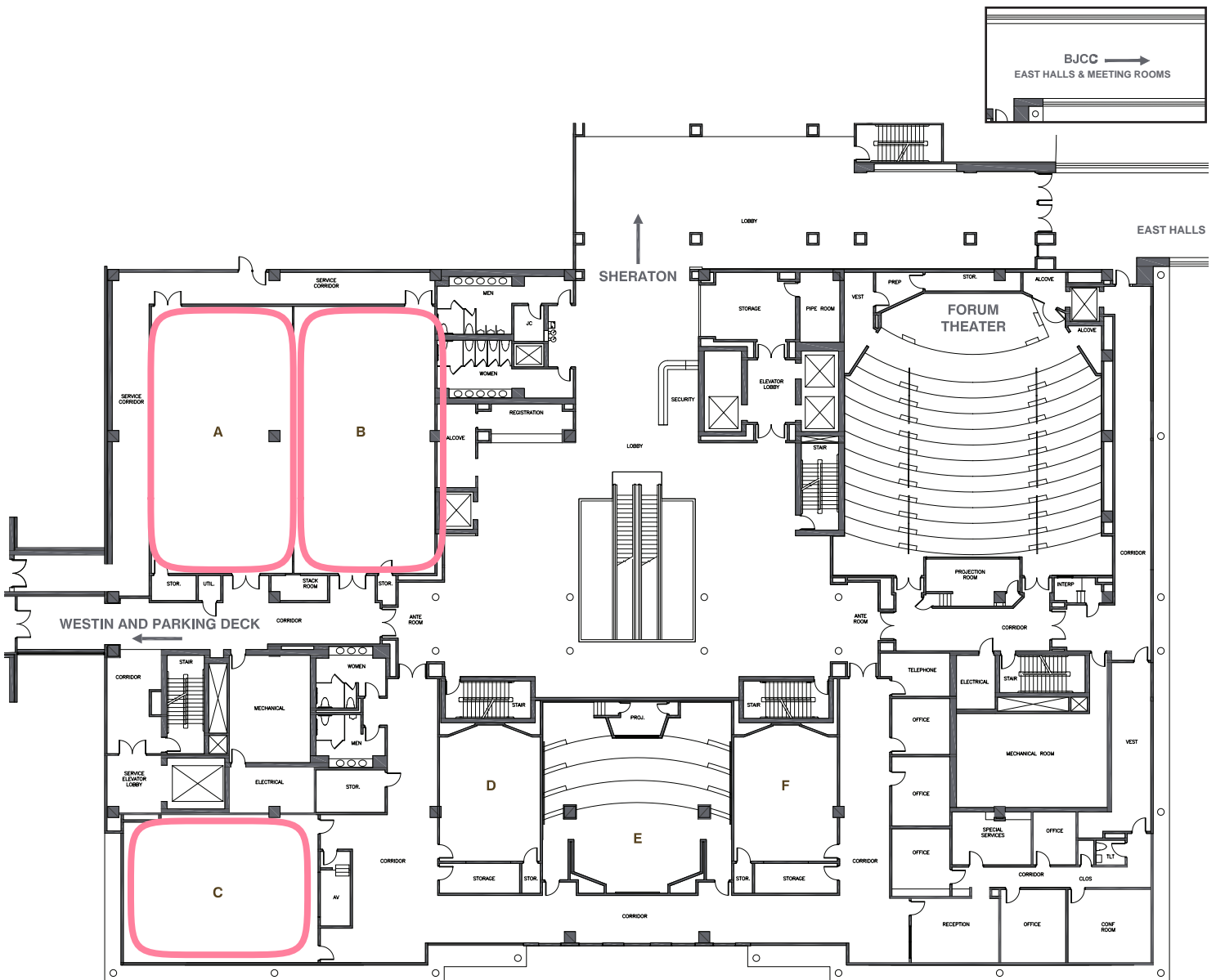

FORUM BUILDING

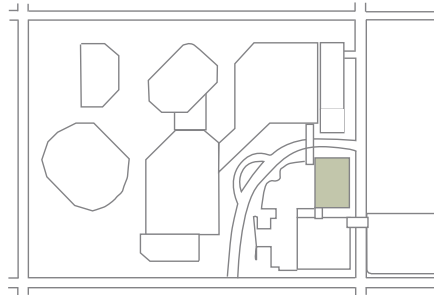

FORUM (3RD FLOOR)

Room	Approx Sq Ft	Ceiling Height	Conference	Theatre	Classroom	U-Shape	Banquet
G	2,270	11'3"	64	210	96	52	160
H	958	11'3"	36	65	36	26	72
I	965	11'3"	36	65	36	26	72
G-I	4,192	11'3"	-	450	168	-	240
H-I	1,923	11'3"	56	200	72	48	144
J	6,300	12"	-	-	-	-	320
K	4,300	12"	-	200	96	-	168
JK	10,600	12"	-	-	-	-	480
L	548	10'1"	24	36	18	-	32

